

From: Blake Caldarera <blake.caldarera@TNC.ORG>

Sent: Friday, March 21, 2025 5:16 PM

To: Information Quality, GS-GIO <InfoQual@usgs.gov>

Subject: [EXTERNAL] Request for Correction of Information submitted under USGS Information Quality Guidelines

This email has been received from outside of DOI - Use caution before clicking on links, opening attachments, or responding.

ATTN: Director, Office of Science Quality and Integrity

Hello,

I would like to open a case to review a potential map error in the USGS National Map Viewer. A landowner on one of the drainage boards with whom I work closely brought this to my attention. He asked me to see if I could have the map corrected. I am told that Little River is misrepresented in the southwestern tip of Clay County near the Black River in Arkansas. The confluence of the two rivers in question is near ear Hubble Bridge (approximately N 36° 17' 50.23", W 90° 41' 55.25").

According to my contact, Little River is misplaced. It should instead be represented by the next river to the west, represented on the USGS map by the dotted line. Little River is perennial, but it should run along the purple line (see USGS map), and the area circled in red should instead denote the intermittent Rankine stream. I've included the supporting maps that were shared with me. Little River-Rankine Inverted map is a snapshot of another USGS map. The other maps A & B were created by a private company. Let me know if you would like additional map details or documentation to affirm the claims of a mapping error. I have no personal knowledge of this area, but I trust the knowledge of my colleagues on this matter.

I will serve as the primary contact on this case, and my contact information is listed below. Please let me know if you have any questions for me.

Thank you,

Blake Calderera

*Agricultural Drainage Project
Manager*

blake.c@tnc.org

p: 501-614-5077

c: 903-736-2582

nature.org

**The Nature
Conservancy**

Arkansas Field Office

601 N. University Ave.

Little Rock, AR 72205

U.S.A.



USGS map

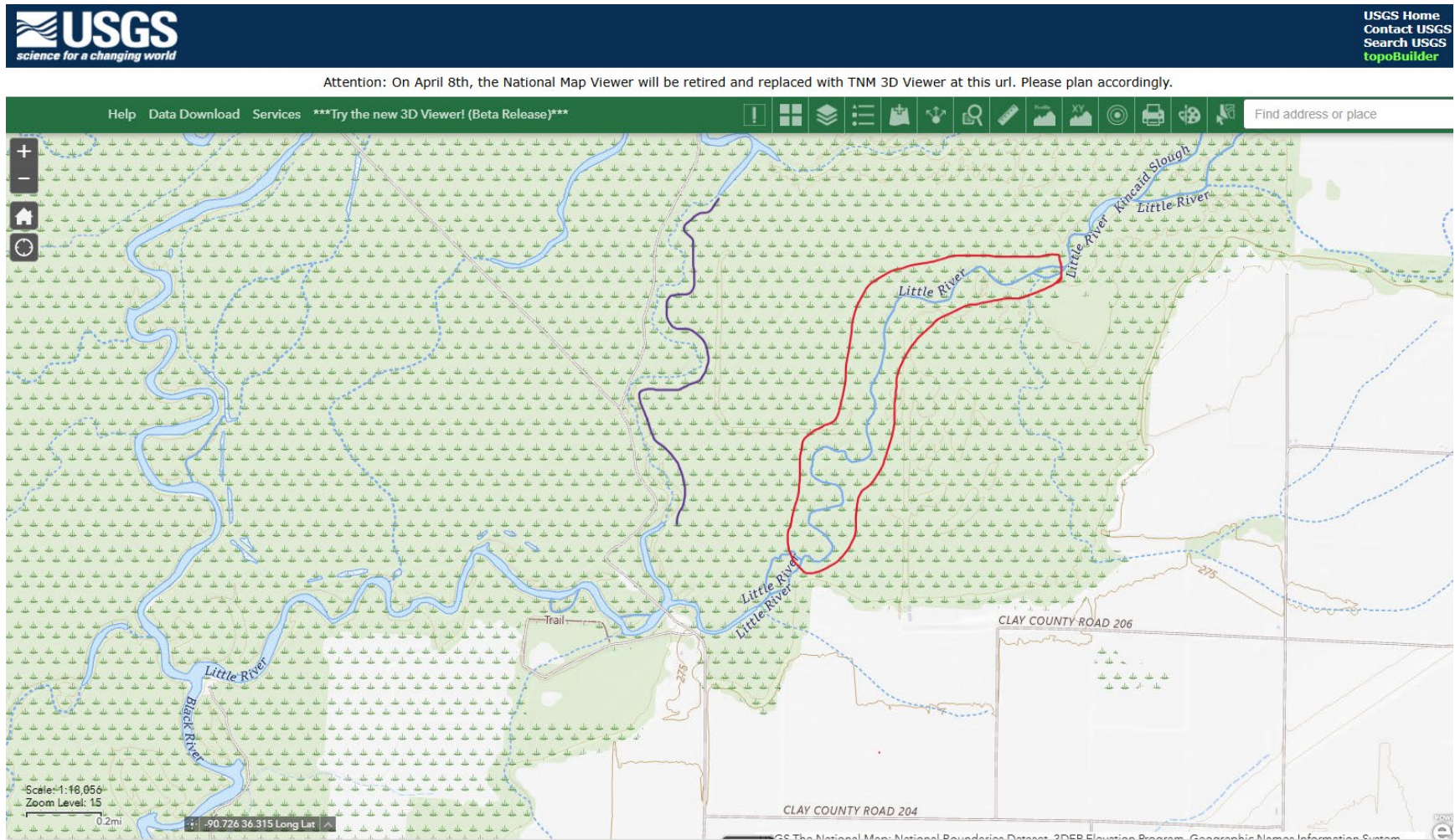

Little River-Rankine Inverted

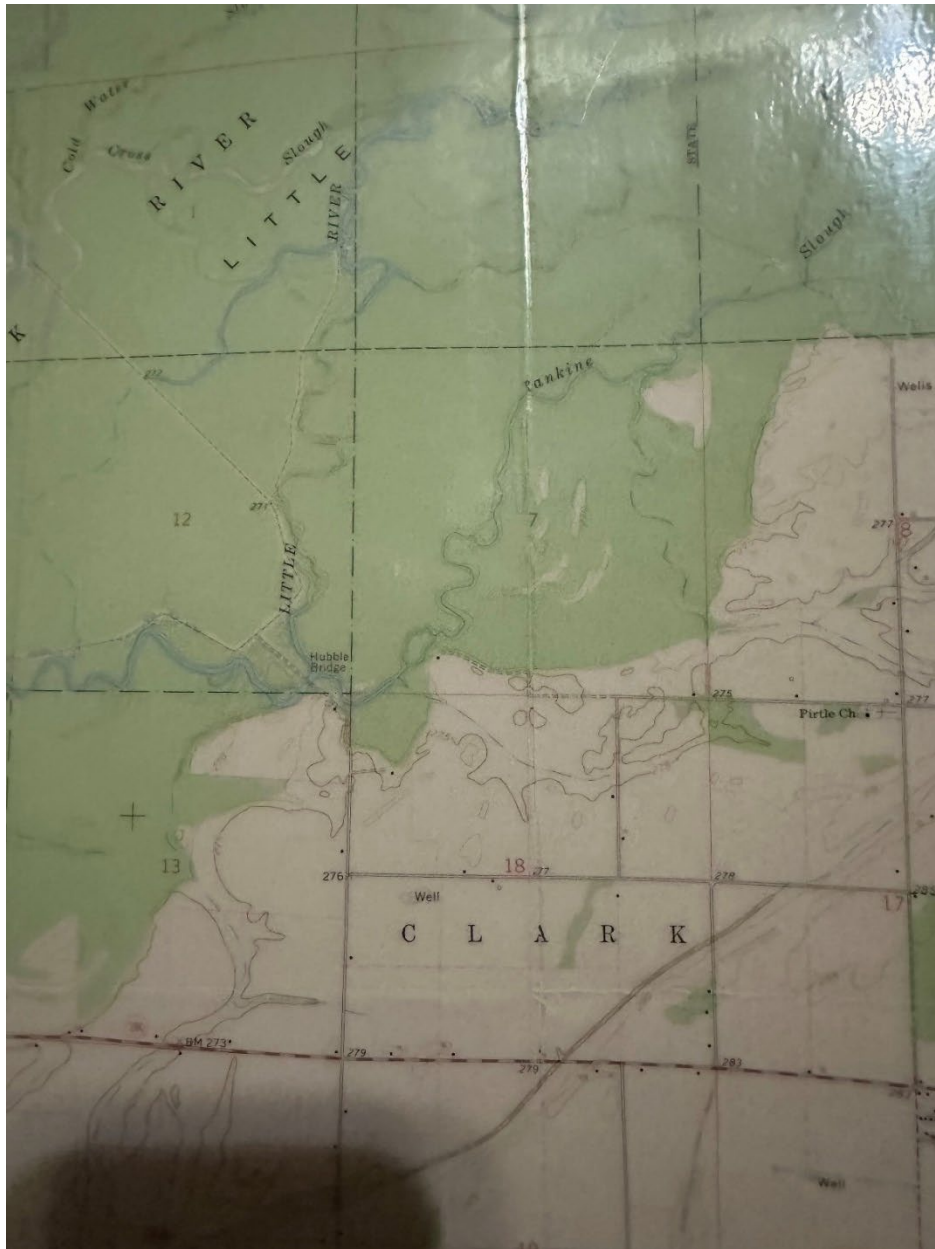

Private Map A



Private Map B

the roads and/or trails shown hereon does not imply that they are open to the general public.
Arkansas Game and Fish Commission regulations do apply.
The accuracy content and completeness of this exhibit is NOT guaranteed.
This exhibit is not a land survey. All boundary lines shown hereon are approximate.
Aerial photography was taken January 15, 2006.
Aerial photography is courtesy of USGS.
Contact Troy Halliburton by email at thalliburton@gohsm.com with questions and/or comments.

DATE: NOVEMBER, 2013

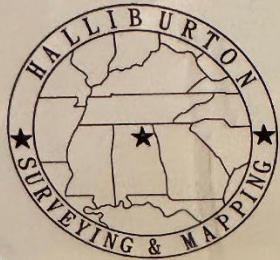

HALLIBURTON
SURVEYING & MAPPING, LLC

PO BOX 18652
HUNTSVILLE, AL 35804
Phone: (256) 503-4639
gohsm.com

2